

Produced from: May 2023

Sensor Basin Electronic
Chrome A7856AA

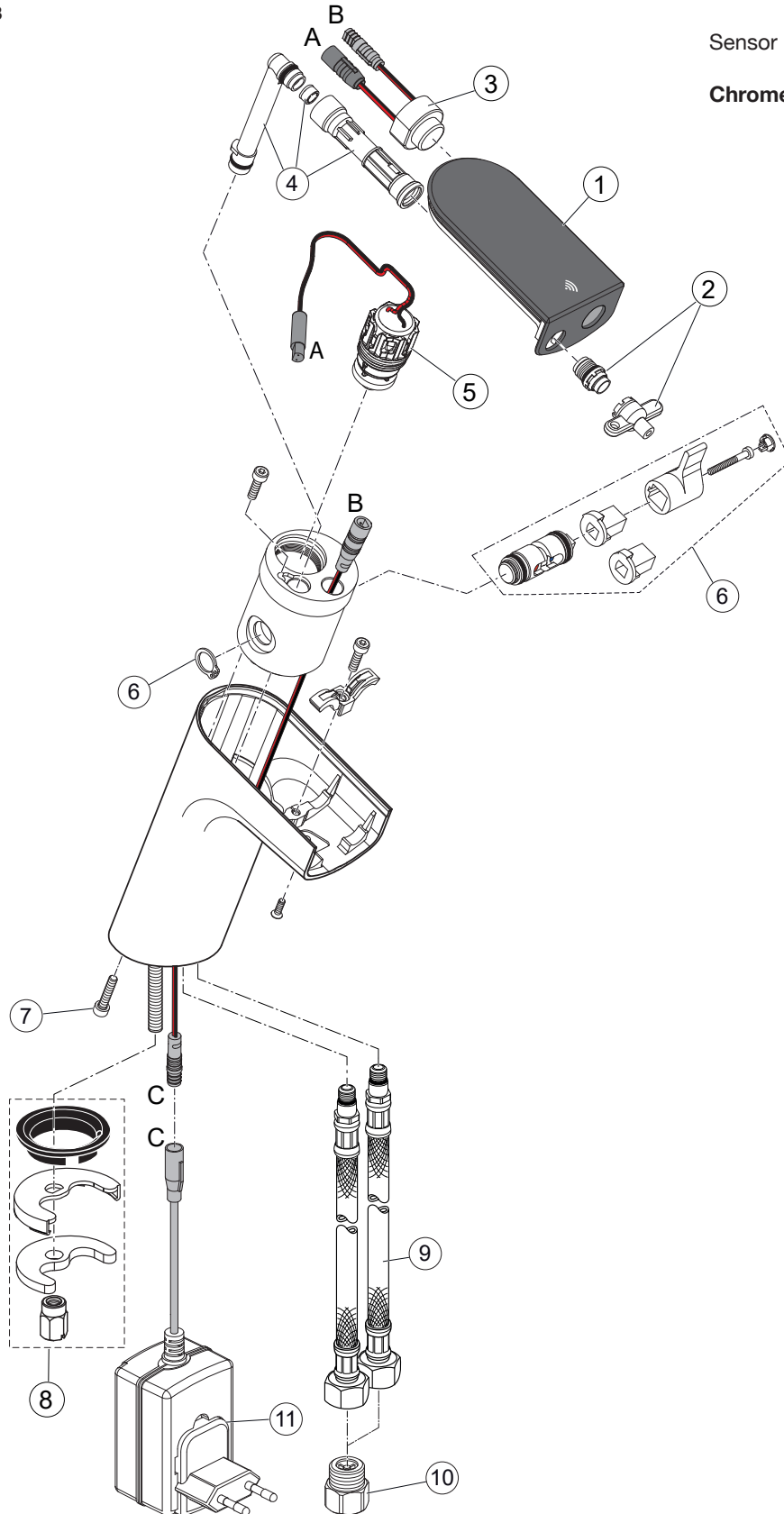

Replace XX with the appropriate finish code

Chrome = AA Onyx Black = B3

Example spare part order:

A 861 681 AA in Chrome

| Pos. | Description | Part-Number | Qty. | Pos. | Description | Part-Number | Qty. |
|------|------------------------|--------------|-------|------|----------------------------|---------------|-------|
| 1 | Acryl Cover cpl. | A 861 534 NU | 1 Set | 8 | Fixation set | A 960 001 NU* | 1 Set |
| 2 | Flowregulator with Key | A 861 531 NU | 1 Set | 9 | Flex. hose M10x1/450-G3/8 | A 860 794 NU | 1 pcs |
| 3 | IR Sensor | A 861 702 NU | 1 pcs | 10 | Check valve G 3/8 cpl. | B 960 844 NU | 2 Set |
| 4 | Connection pipe | A 861 680 NU | 1 Set | 11 | AC-Adapter 6,5V DC / 0,92A | F 961 033 NU | 1 pcs |
| 5 | Solenoidvalve 6V G1/2 | F 961 050 NU | 1 pcs | | Extension cable 2m | A 960 635 NU | 1 pcs |
| 6 | Pre-Mixer cpl. | A 861 681 XX | 1 Set | | | | |
| 7 | Screw M4X20 Din 912 | A 962 268 NU | 4 pcs | | | | |

* Universal-Set (not all parts needed)