

Produced from: May 2023

Sensor Basin Electronic
Chrome **A7858AA**

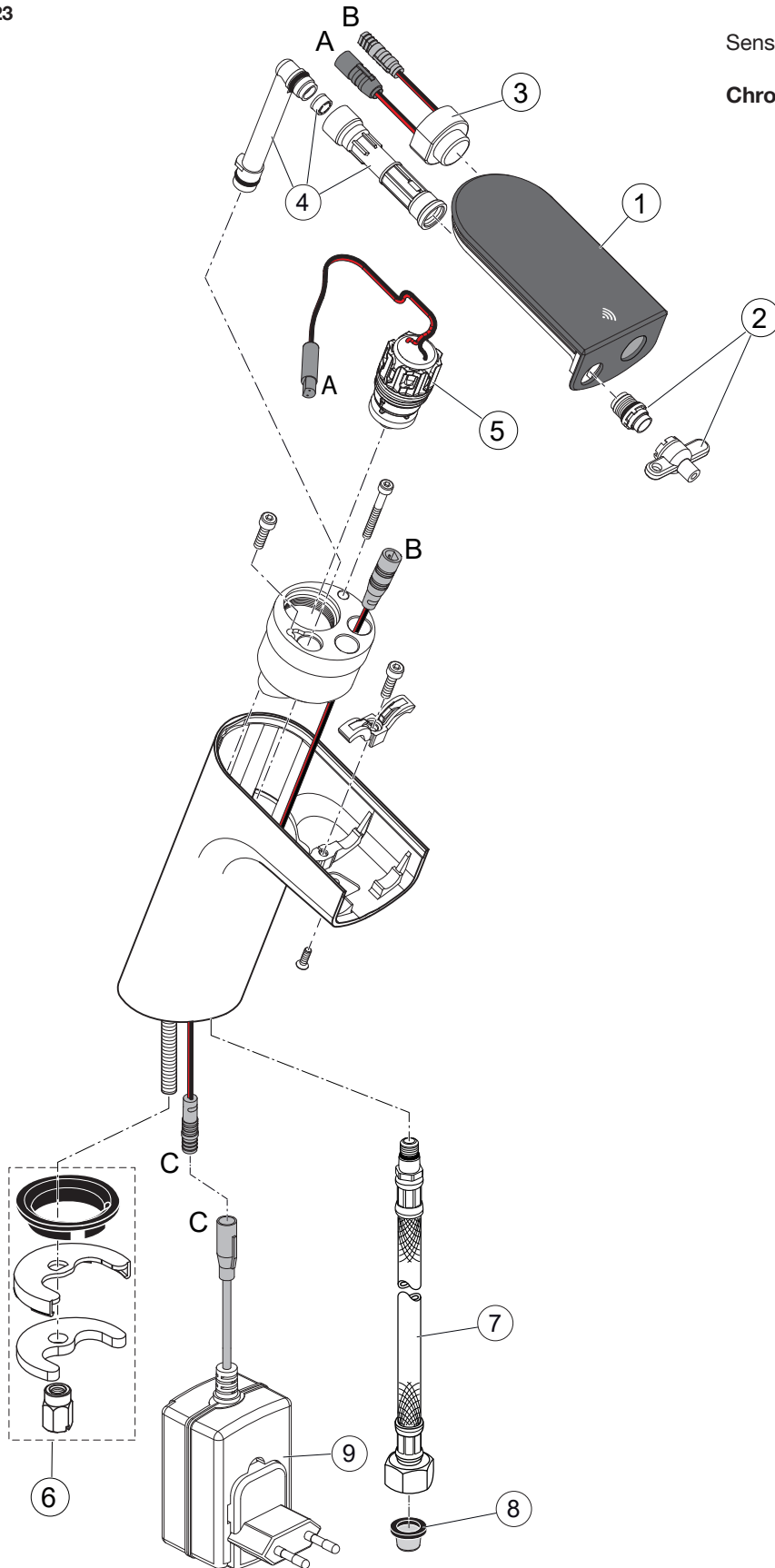

Pos.	Description	Part-Number	Qty.	Pos.	Description	Part-Number	Qty.
1	Acryl Cover cpl.	A 861 534 NU	1 Set	9	Strainer Ø15	F 961 032 NU	1 pcs
2	Flowregulator with Key	A 861 531 NU	1 Set	10	AC-Adapter 6,5V DC / 0,92A	F 961 033 NU	1 pcs
3	IR Sensor	A 861 702 NU	1 pcs		Extension cable 2m	A 960 635 NU	1 pcs
4	Connection pipe	A 861 680 NU	1 Set		<i>* Universal-Set (not all parts needed)</i>		
5	Solenoidvalve 6V G1/2	F 961 050 NU	1 pcs				
6	Fixation set	A 960 001 NU*	1 Set				
7	Flex. hose M10x1/450-G3/8	A 860 794 NU	1 pcs				